

CADWorx fieldPipe for Leica fieldPro Plant As-built in Real-time

CADWorx fieldPipe for Leica fieldPro is the only product that combines Leica Geosystems' TPS accuracy, fieldPipe's on-site, real-time, object oriented survey power and COADE CADWorx Plant Professional's specification driven AutoCAD based modeling capabilities to as-built plant infrastructures.

CADWorx fieldPipe comes complete with Leica fieldPro's software and its TPS option to update as-built documentation, verify new construction or stakeout from design CAD files.

CADWorx fieldPipe comes complete with CADWorx Plant Professional piping components, equipment, steel, HVAC, cable trays capabilities as well as ISOGEN, NavisWorks® Roamer and bi-directional links to CAESAR II stress analysis software.

Features and Benefits

- TPS measurement accuracy
- Point and measure component placement
- Quicker and easier as-builts
- Improved safety
- Piping specifications and automatic isometrics
- Steel, equipment, ducting and cable trays
- Collision checking
- Links to stress analysis



- when it has to be **right**

Leica
Geosystems

CADWorx fieldPipe for Leica fieldPro

TPS Measurement Accuracy

CADWorx fieldPipe leverages the power and precision of Laser EDM technology onboard Leica Geosystems' Total Station. Leica fieldPro ~ fieldPipe allows users to model any piping system with pinpoint accuracy.

Point and Measure Component Placement

Creating CADWorx fieldPipe as-built models is easy; set up the Total Station, point the laser at a piping item and pick components from the toolbar. Presto! The component is placed in the model at exactly that position.

Quicker and Easier As-builts

Measure and model on site in real-time hundreds of piping components from only a few locations – quickly and easily!

Improved Safety

CADWorx fieldPipe makes as-built work safer by reducing the climbing and clambering associated with measuring and sketching existing piping systems.

Piping Specifications and Automatic Isometrics

CADWorx fieldPipe includes ready-to-use metric and imperial specifications with over 60,000 components to model any pipe run. Automatic isometrics from single or multiple pipe runs can be created from your CADWorx fieldPipe models.

Steel, Equipment, Ducting and Cable Trays

CADWorx fieldPipe is a comprehensive solution. It includes full steel and equipment capabilities. (See CADWorx Steel Professional and Productivity Modules Fact Sheets). Ducting and cable trays are also bundled.

Collision Checking

Built in clash detection from within your model and against external referenced files are included.

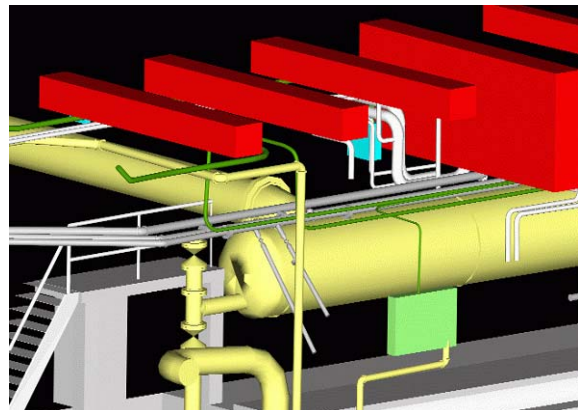

Measure once – Model on Site – Deliver faster

Links to Stress Analysis and Stress Isometrics

CADWorx fieldPipe has bi-directional links to the world's most widely used stress analysis package CAESAR II. Now you can go directly from the field to analysis quickly and with total accuracy.

Technical Specs

Runs on AutoCAD Versions 2004 to 2007

Application Areas

Process and Plant As-builts for Design, Piping, Equipment, Steelwork, Petrochemical, Chemical, Power, Food, Beverage, Brewing, Pharmaceutical, Water Treatment, Building Services and Architectural.

CADWorx and CAESAR II are registered trademarks of COADE, Inc.

Illustrations, descriptions and technical specifications are not binding and may change.
Printed in Switzerland - Copyright Leica Geosystems AG, Heerbrugg, Switzerland 2006.
757226en - X.06